

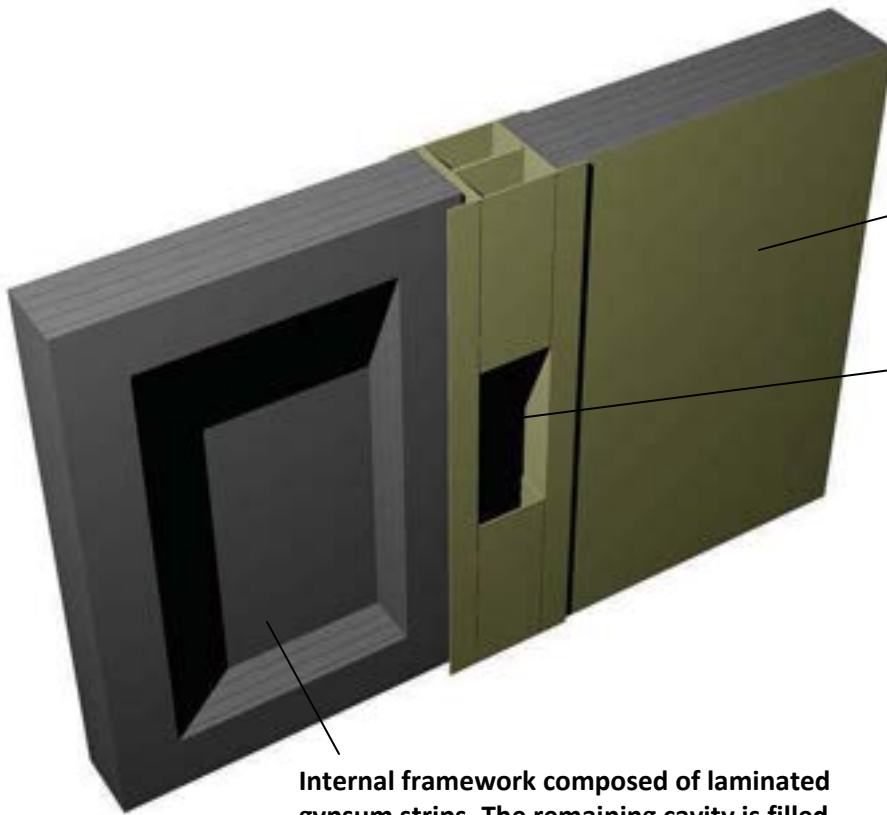

MODULAR OFFICES & ENCLOSURES • PARTITIONS • BOOTHS • MEZZANINES

Controlling sound with Sound-stop Panels from IPO!



Available panel surfaces include vinyl, 24ga steel, and FRP

Stud raceways are insulated with rock wool

Internal framework composed of laminated gypsum strips. The remaining cavity is filled with rock wool insulation

STC data for steel clad sound stop panels

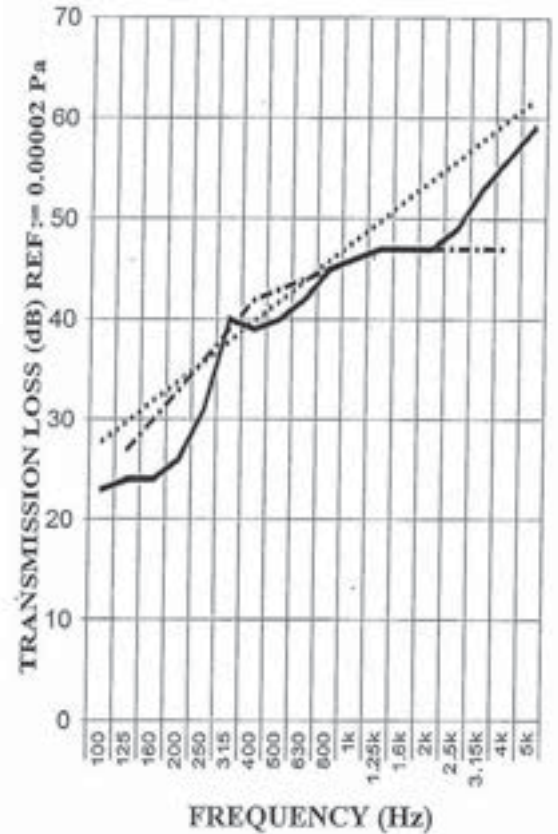

STC = 43

— TRANSMISSION LOSS
 - - - SOUND TRANSMISSION LOSS CONTOUR

STC Comparison:

1-3/4" Hardboard	STC 24
3" Hardboard	STC 24
1-3/4" NC (1/2" gyp/foam/gyp).....	STC 31
3" NC	STC 32
3" Sound-stop (vinyl covered 5/8" gyp).....	STC 41
3" Sound-stop (24ga steel over 5/8" gyp)...	STC 43