

MEDICAL SUPPLY CABINETS



● ● ● ● ●
SOUTHWEST SOLUTIONS GROUP

SouthwestSolutions.com | 800-803-1083 | info@southwestsolutions.com



INSTRUMENTEN
0.1m 2

● ● ● ● ●
SOUTHWEST SOLUTIONS GROUP

SouthwestSolutions.com | 800-803-1083 | info@southwestsolutions.com

PLANNING & DESIGN

Using our internal capabilities and our 30 years' experience in design and implementation of storage rooms and clinical areas, we will **enhance your facility design process and provide you with dedicated cost-effective storage solutions** for each of the areas where disposables and medication need to be stored and dispatched.

By using AutoCad design blocks, Revit files and 3D drawings we can assist your equipment planner/architect during the design phase with full room layouts.

Our storage experts will work closely with your supply chain team and clinical staff to ensure the most cost effective and efficient design is created to meet your needs.



OUR WORK PROCESS

STEP 1

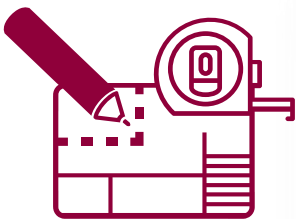

Perform a physical walk-through and assessment of all relevant storage locations & create CAD drawings for each storage location

OR

Receive facility CAD files from the architects

STEP 2



Lay out the storage unit blocks in CAD drawings according to customer needs

STEP 3



3D room illustrations to end users



STEP 4

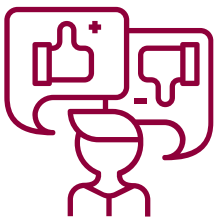

Customer feedback

STEP 5



Integration of customer feedback to the suggested design

STEP 6

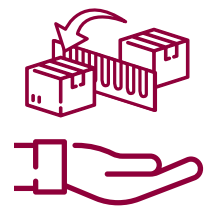

Performing TURN-KEY Kanban Installation

CATH LAB INSTALLATION

USING A PROVEN TRACK RECORD, WE WILL ASSIST IN PLANNING YOUR STORAGE AREAS THROUGHOUT YOUR NEW OR RENOVATED FACILITY

CAD DRAWINGS

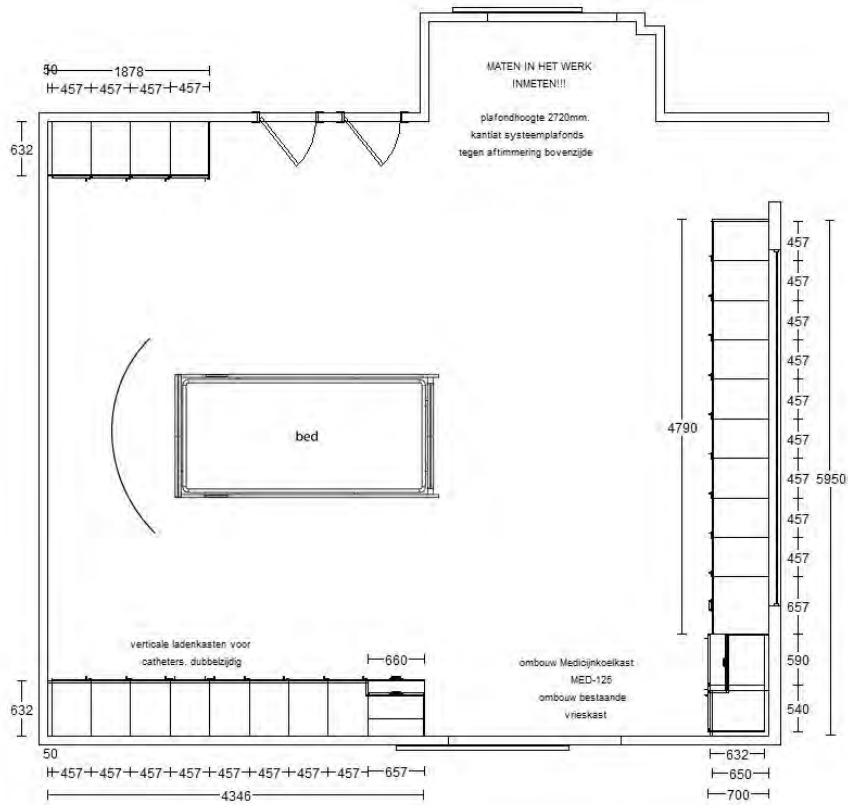

3D ILLUSTRATIONS

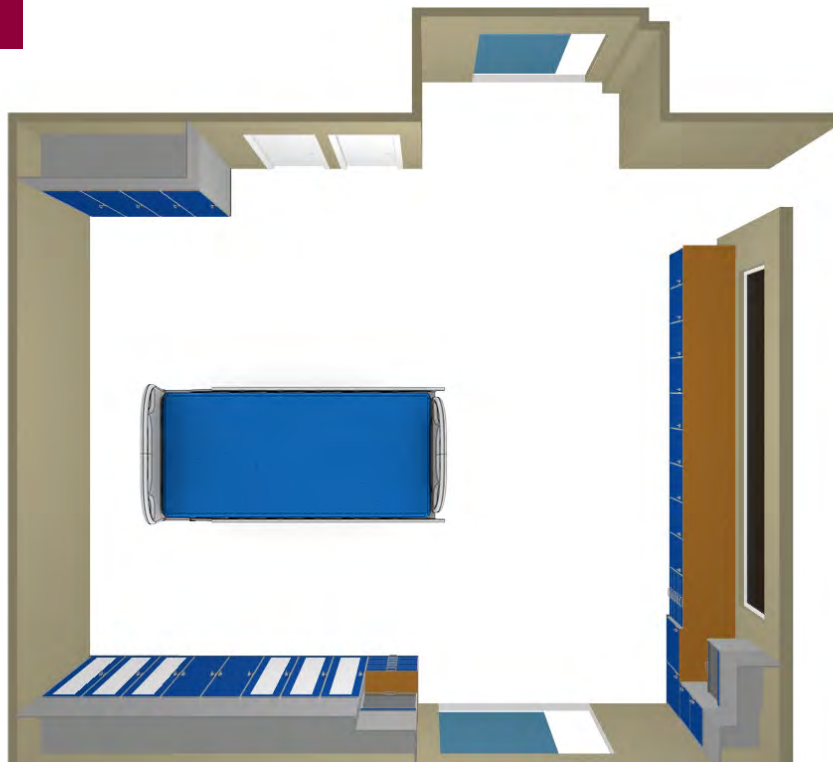

FURNISHED



FURNISHED



CENTRAL STERILIZATION

CAD DRAWINGS

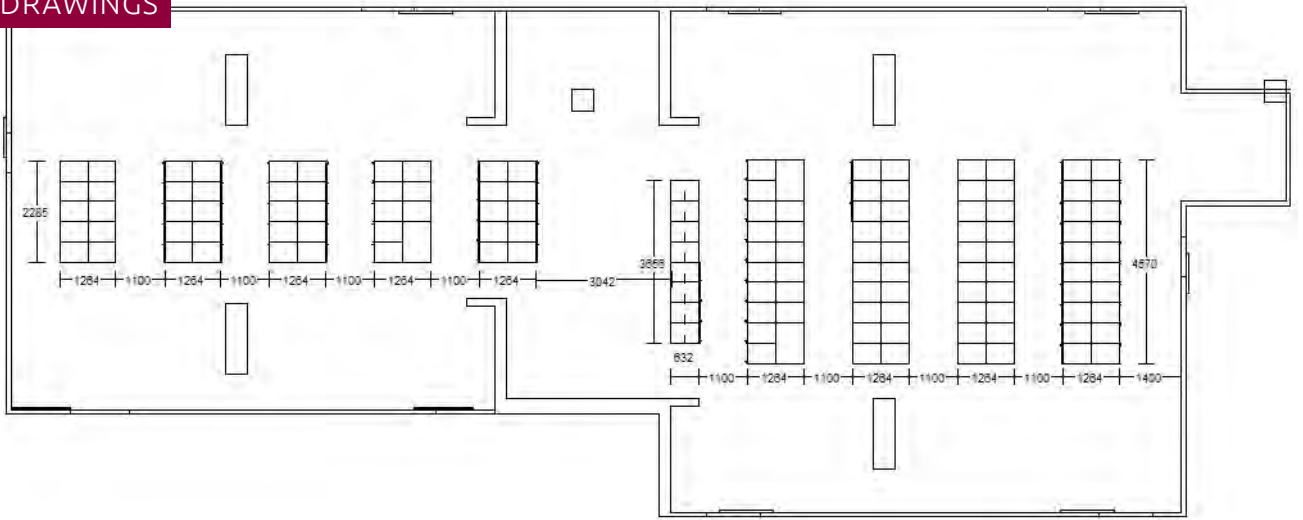

3D ILLUSTRATIONS

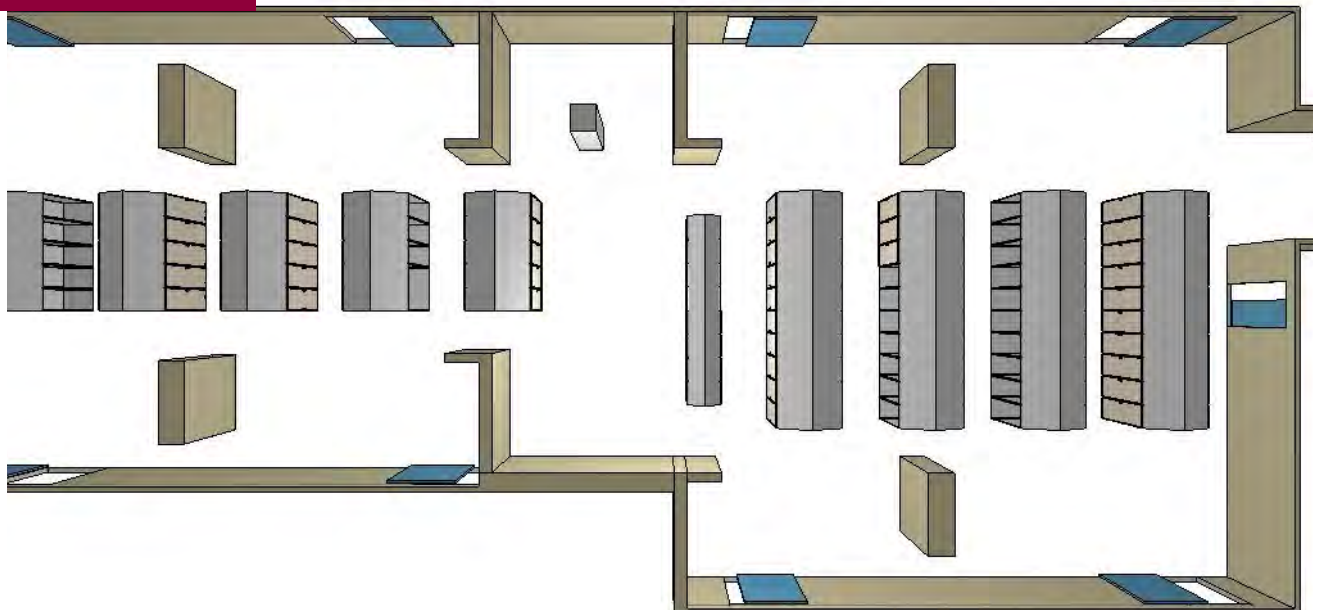

FURNISHED



WORKSPACE UTILIZATION



Gaps or dead air spaces are required between shelves in order to enable access to the products at the back of the shelves

Products on top levels can not be easily accessed

1 SQM/SQF of flat shelving foot print



Baskets are fully retractable - hence, no gaps are needed between the baskets, no space is wasted and easy access to supplies at the back of the basket is assured

Clear line of sight, easy and ergonomic access to all baskets at the higher levels

Can be decreased into 0.65 SQM/SQF footprint of dense storage

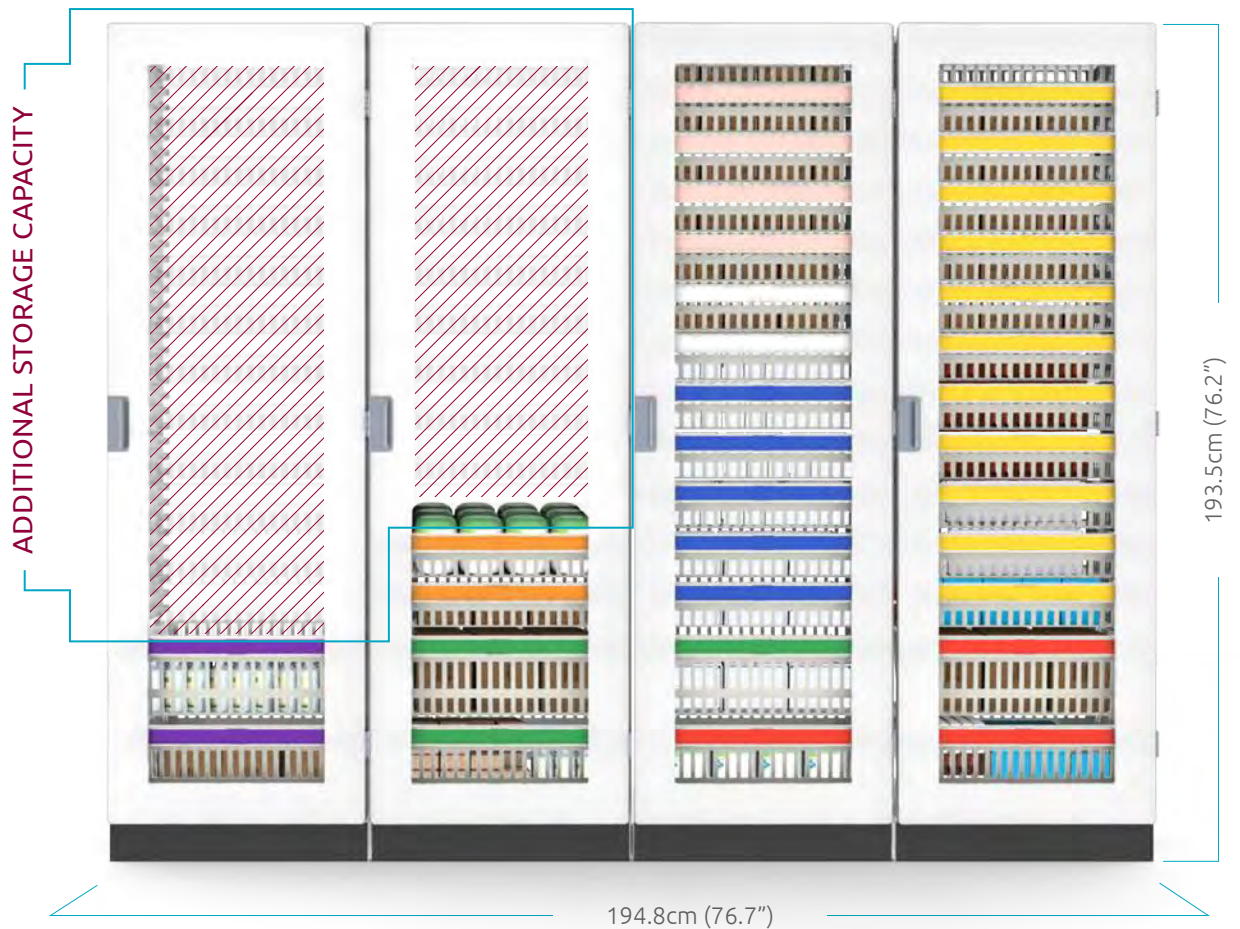

33% to 50% more storage space per sqt/sqm

UNIQUE FEATURES

QUIET CLOSURE

All around polymer dust and noise reduction seal



PULL & TILT

While opening the baskets on the upper levels, the baskets will be tilted 116 degrees, enabling a line of sight and easy removal of products

RIGID STRUCTURE

Fully glued corpus, 19mm European dense chipboard

TOE KICK

10 cm of laminated plywood plinth with a set of levelling feet





COLOR CODING

Ergonomic basket handles with interchangeable color strips for color coding purpose

DOOR HINGES

Anodized aluminum hinges

SOLID DOOR

Front solid door with HPL/Formica finish

TELESCOPIC SLIDES

Telescopic slides allowing load of up to 40KG

TECHNICAL DATA

MATERIAL

Side walls: 19mm melamine coated chipboard + ABS side panels (interior)
Plinth: 19mm laminated plywood
Handle: anodized aluminum
Edge: 3mm polypropylene
Glass door: 3mm reinforced glass
Hinges: 270 degree opening

Tambour door: 16mm polypropylene roller shutter

CLEANING

Cabinets can be cleaned with a damp cloth. Standard pH-neutral detergents and disinfectants can be used

COLOR

Sides: polar white
Door: light grey / silver
Plinth: dark grey

LOCKING

Doors can be fitted with a key or code lock



Tambour door



Solid door



Glass door

HEAT RESISTANCE

Max. continuous: 70° C

Max. short term: 90° C

MAXIMUM LOAD

20kg per basket

STANDARD

HTM71 / ISO standard

* Depths change according to door type

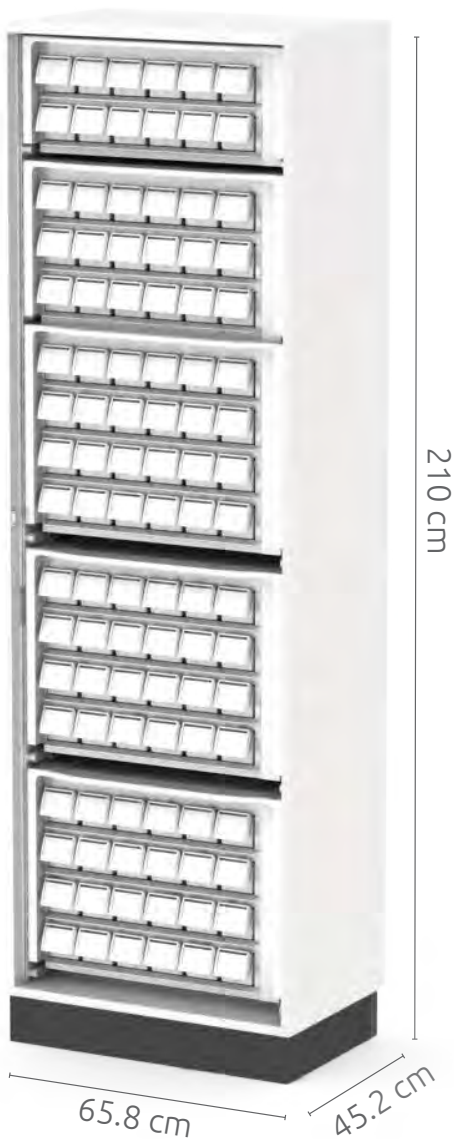

No door



Working area configuration



Tambour door combined with drawer

SMART AND COST EFFECTIVE DESIGN FOR YOUR WORK SPACE

Design your cabinetry to maximize ease of use, the most often used items will be stored in ball-bearing glides drawers at the heights of 60cm to 110cm (24" to 43"), items that are not often used will be placed in retractable baskets and trays on higher levels and behind doors





SIDE PANELS FOR MEDICAL CABINETS

With PEGASUS MEDICAL's side panels your cabinets will now accommodate ISO trays and baskets

TILT PANELS

9 INSERTIONS

For maximum storage

FUNCTIONALITY

Tilt functionality while modules are pulled out

ACCESSORIES

Support wheels for "tilt" side panels (PNWL-SET)



Tilt Panel U-Type
56.5cm deep, 37.5cm high
PNL(U)-NW (USA: PNL-U-N)



Tilt Panel E-Type
36.5cm deep, 37.5cm high
PNL(E)-NW (USA: PNL-E-N)

PNWL-SET



"click-in"
wheel

FLEX PANELS

4 INSERTIONS

Horizontal or angle basket insertion

FUNCTIONALITY

Fixed angled position in high levels, for easy product picking and maximum visibility

ACCESSORIES

Support wheel for "Flex" side panels (PNLWHEEL)



"Flex" Panel E-Type
40cm deep, 30cm high
PNL(EU) (USA: PNL-E)



"Flex" Panel U-Type
60cm deep, 30cm high
PNL(US) (USA: PNL-U)

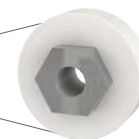

"scraw-in"
wheel

PNLWHEEL

ISO ACCESSORIES FOR MEDICAL CABINETS

TELESCOPIC SLIDES

PEGASUS MEDICAL offers you the possibility of combining telescopic slides made of high-quality steel that can hold up to 40kg *



BBG-RK-U (60cm)



BBG-RK-E (40cm)

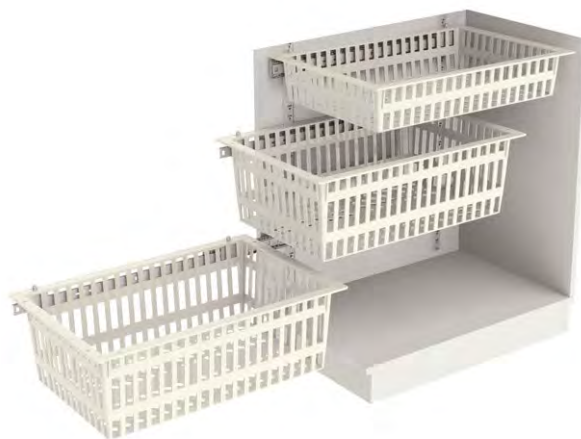

* For safety reasons it is not allowed to load more than 10 kg in baskets placed on telescopic slides at upper levels (above 140cm)

DRAWER PULLS

Injected ABS drawer fronts

White 5cm drawer

DWR-PULL-E-W + DWR-FRNT-E-5-W

White 10cm drawer

DWR-PULL-E-W + DWR-FRNT-E-10-W

White 20cm drawer

DWR-PULL-E-W + DWR-FRNT-E-20-W



BASKET/TRAY HANDLES

Ergonomic grip & color coding



E type handle PC-ABS
LBL-HDL-E-B



E type handle PC-ABS
LBL-HDL-U-B

TRAYS AND BASKETS

ABS CREAM COLOR



10cm TRAY - T104060ND
(No Dividers)
LID - L4060



5cm TRAY - T054060



10cm TRAY - T104060



20cm TRAY - T204060



5cm TRAY - T053040



10cm BASKET - B103040



10cm BASKET - B104060



20cm BASKET - B204060

POLYCARBONATE CLEAR COLOR

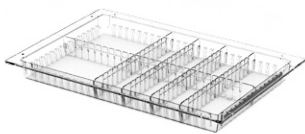

5cm TRAY - T054060PC

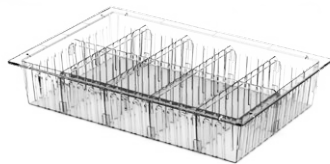

10cm TRAY - T104060PC



20cm TRAY - T204060C



20cm BASKET - B204060PC

ANTIMICROBIAL MODULES

Proven to reduce the levels of bacteria on the module surface by up to 99% within 24 hours.

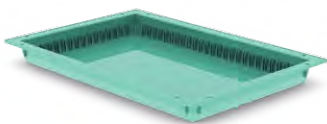

5cm TRAY - T054060-AM



10cm TRAY - T104060-AM



20cm TRAY - T204060-AM

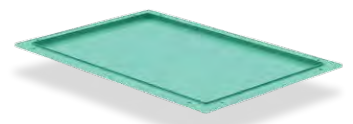

LID - L4060-AM